

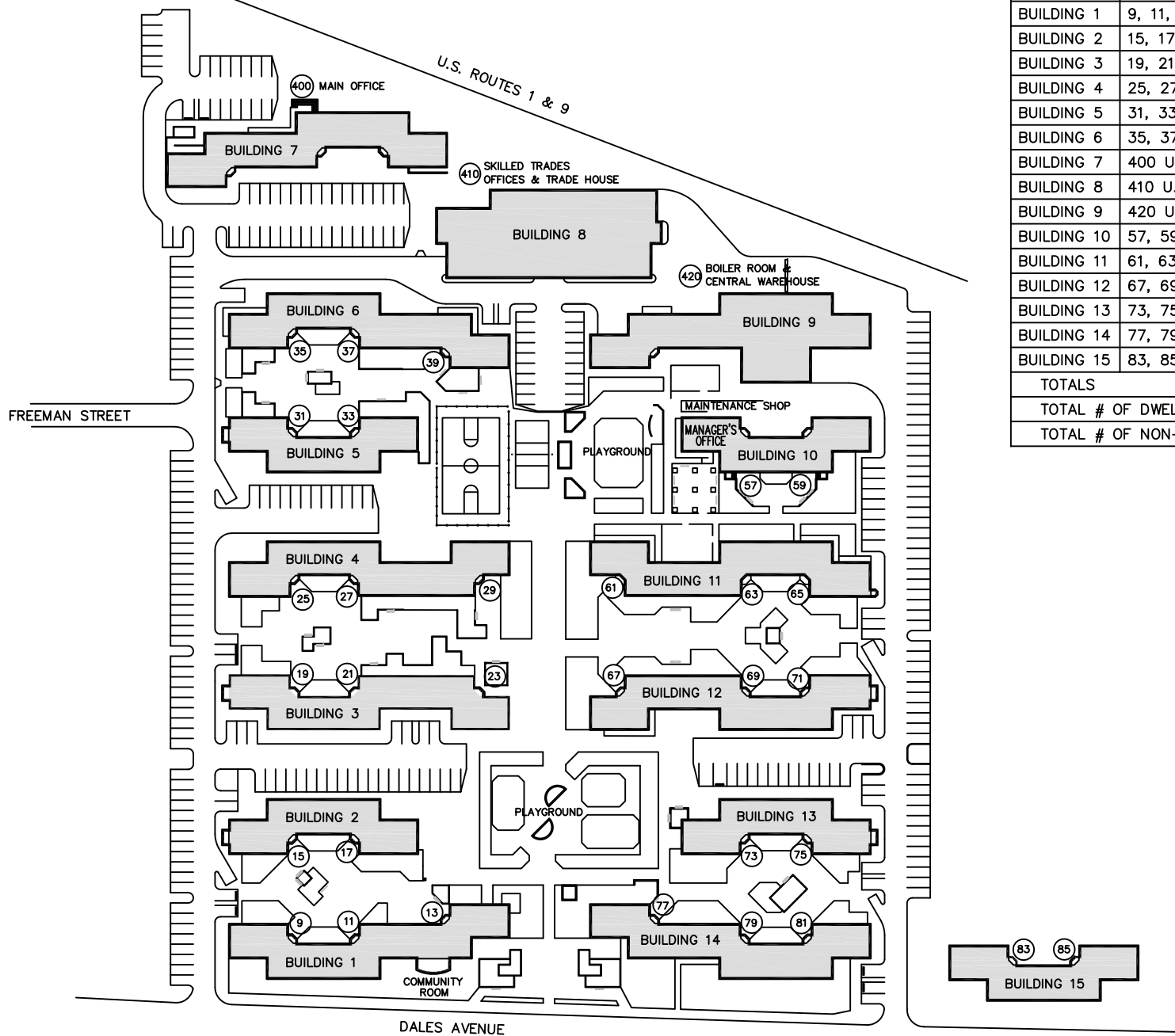

# Site Location Maps

**Building Communities...Creating Opportunities...Transforming Lives**

Updated 04/2014



BLDG. #	ADDRESSES	BLDG. AREA*	# OF UNITS
BUILDING 1	9, 11, 13 DALES AVENUE	8,609 SF	20
BUILDING 2	15, 17 DALES AVENUE	5,756 SF	14
BUILDING 3	19, 21, 23 DALES AVENUE	8,609 SF	23
BUILDING 4	25, 27, 29 DALES AVENUE	8,609 SF	23
BUILDING 5	31, 33 DALES AVENUE	5,756 SF	15
BUILDING 6	35, 37, 39 DALES AVENUE	8,609 SF	24
BUILDING 7	400 U.S. HIGHWAY 1	8,609 SF	0
BUILDING 8	410 U.S. HIGHWAY 1	14,041 SF	0
BUILDING 9	420 U.S. HIGHWAY 1	11,542 SF	0
BUILDING 10	57, 59 DALES AVENUE	5,756 SF	13
BUILDING 11	61, 63, 65 DALES AVENUE	8,609 SF	23
BUILDING 12	67, 69, 71 DALES AVENUE	8,609 SF	23
BUILDING 13	73, 75 DALES AVENUE	5,756 SF	16
BUILDING 14	77, 79, 81 DALES AVENUE	8,609 SF	24
BUILDING 15	83, 85 DALES AVENUE	5,756 SF	15
TOTALS		123,235 SF	233
TOTAL # OF DWELLING UNITS			228
TOTAL # OF NON-DWELLING UNITS			5

\*GROSS FIRST FLOOR AREA

SITE AREA: 12.33 AC  
OLD TAX BLOCK: 1627.1 LOT: A



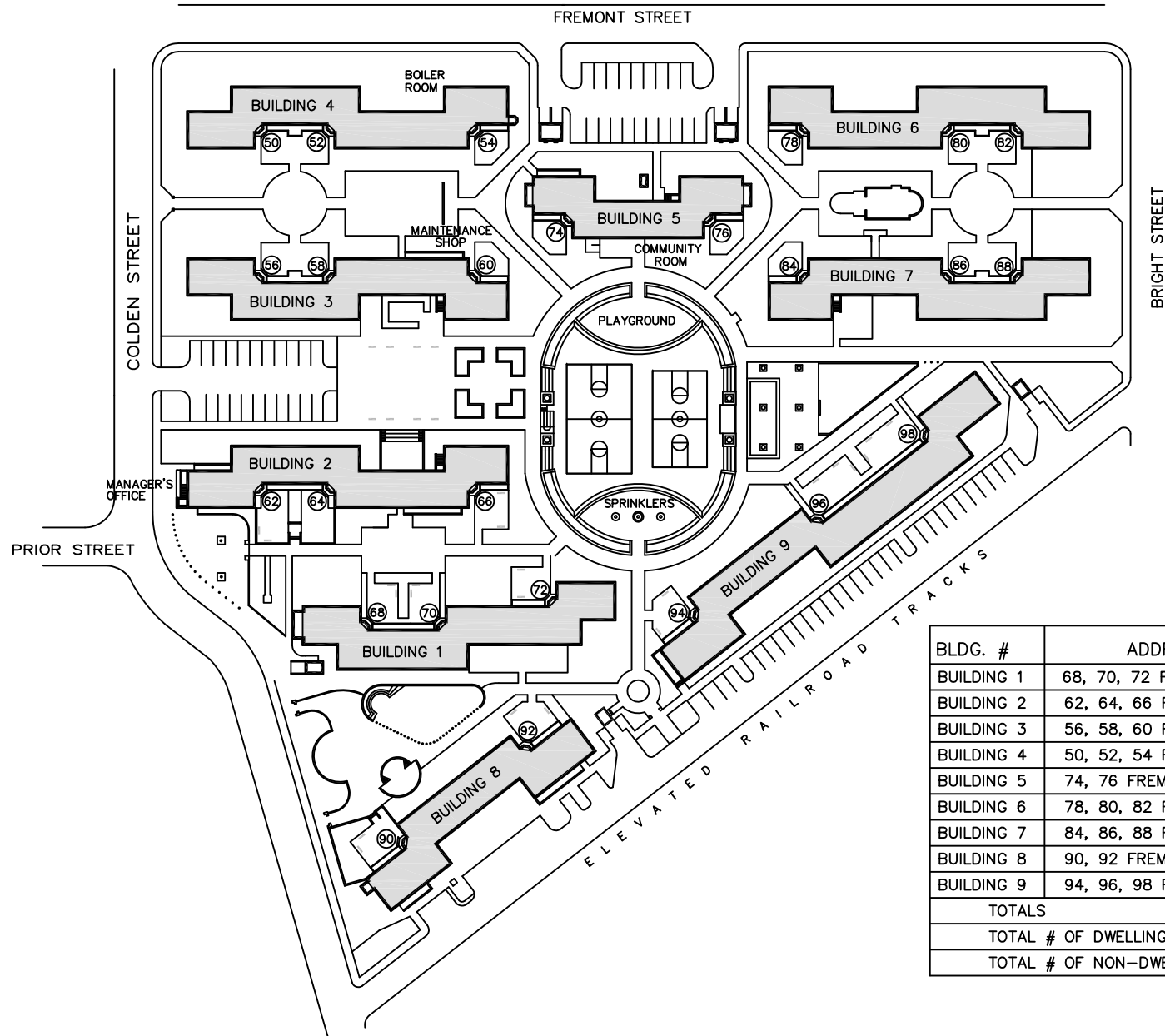

BLDG. #	ADDRESSES	BLDG. AREA*	# OF UNITS
BUILDING 1	68, 70, 72 FREMONT STREET	8,525 SF	36
BUILDING 2	62, 64, 66 FREMONT STREET	8,643 SF	36
BUILDING 3	56, 58, 60 FREMONT STREET	8,643 SF	36
BUILDING 4	50, 52, 54 FREMONT STREET	8,643 SF	35
BUILDING 5	74, 76 FREMONT STREET	5,779 SF	24
BUILDING 6	78, 80, 82 FREMONT STREET	8,584 SF	36
BUILDING 7	84, 86, 88 FREMONT STREET	8,584 SF	36
BUILDING 8	90, 92 FREMONT STREET	7,069 SF	32
BUILDING 9	94, 96, 98 FREMONT STREET	11,200 SF	48
TOTALS		75,670 SF	319
TOTAL # OF DWELLING UNITS			307
TOTAL # OF NON-DWELLING UNITS			12

\*GROSS FIRST FLOOR AREA

SITE AREA: 7.68 AC  
OLD TAX BLOCK: 2114 LOT: K1

BLDG. #	ADDRESSES	BLDG. AREA*	# OF UNITS
BUILDING 1	9, 11 PALISADE AVENUE	5,779 SF	32
BUILDING 2	13, 15, 17 PALISADE AVENUE	8,584 SF	40
BUILDING 3	19, 21, 23 PALISADE AVENUE	8,584 SF	40
BUILDING 4	27, 29, 33, 35 PALISADE AVENUE	11,082 SF	64
BUILDING 5	37, 39 PALISADE AVENUE	5,354 SF	24
BUILDING 6	41, 43 PALISADE AVENUE	5,354 SF	24
TOTALS		44,737 SF	224
TOTAL # OF DWELLING UNITS			221
TOTAL # OF NON-DWELLING UNITS			3

\*GROSS FIRST FLOOR AREA

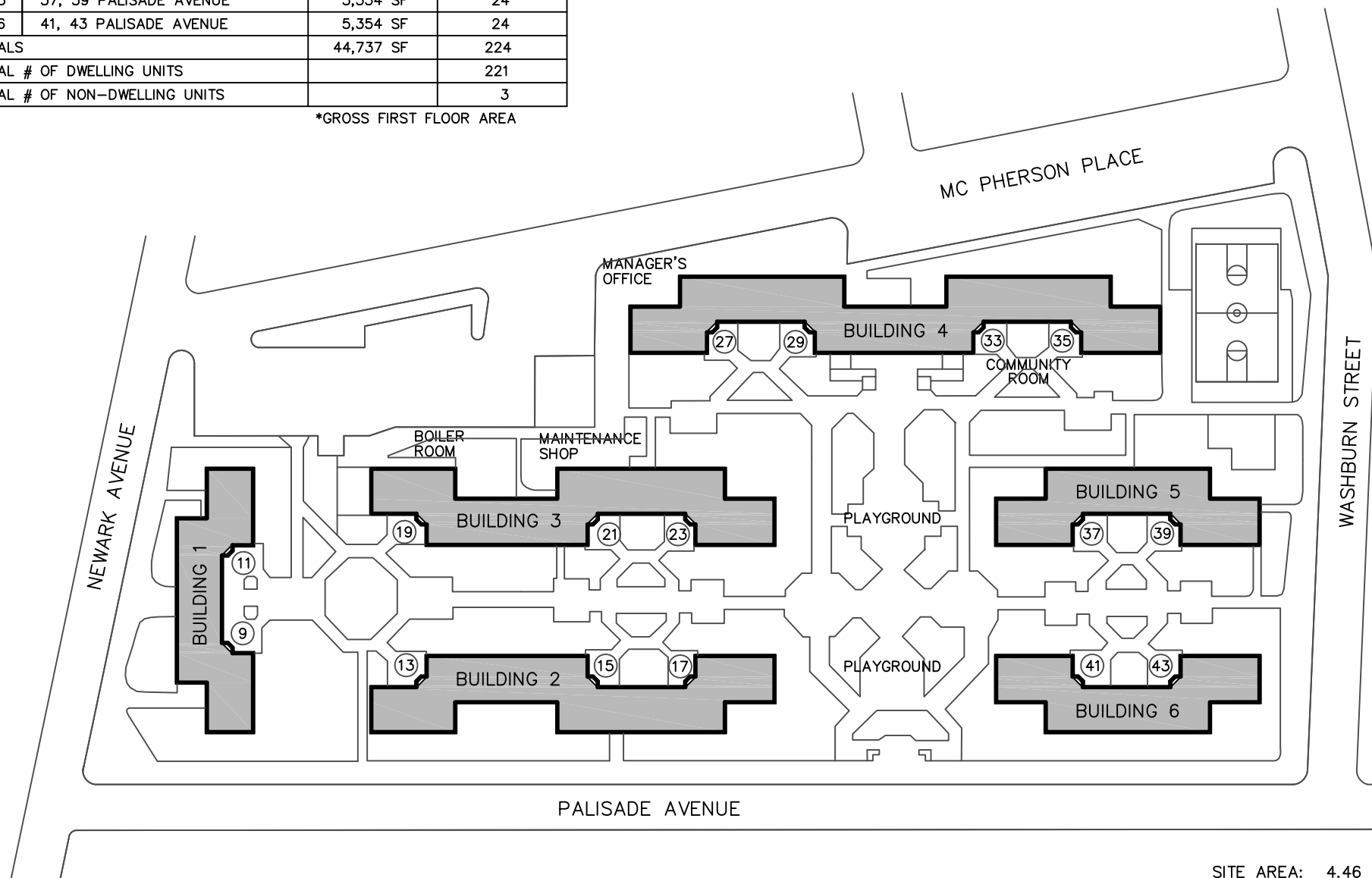

SITE AREA: 4.46 AC  
OLD TAX BLOCK: 532.1 LOT: A2

JERSEY AVENUE

SIXTEENTH STREET

ERIE STREET

FIFTEENTH STREET

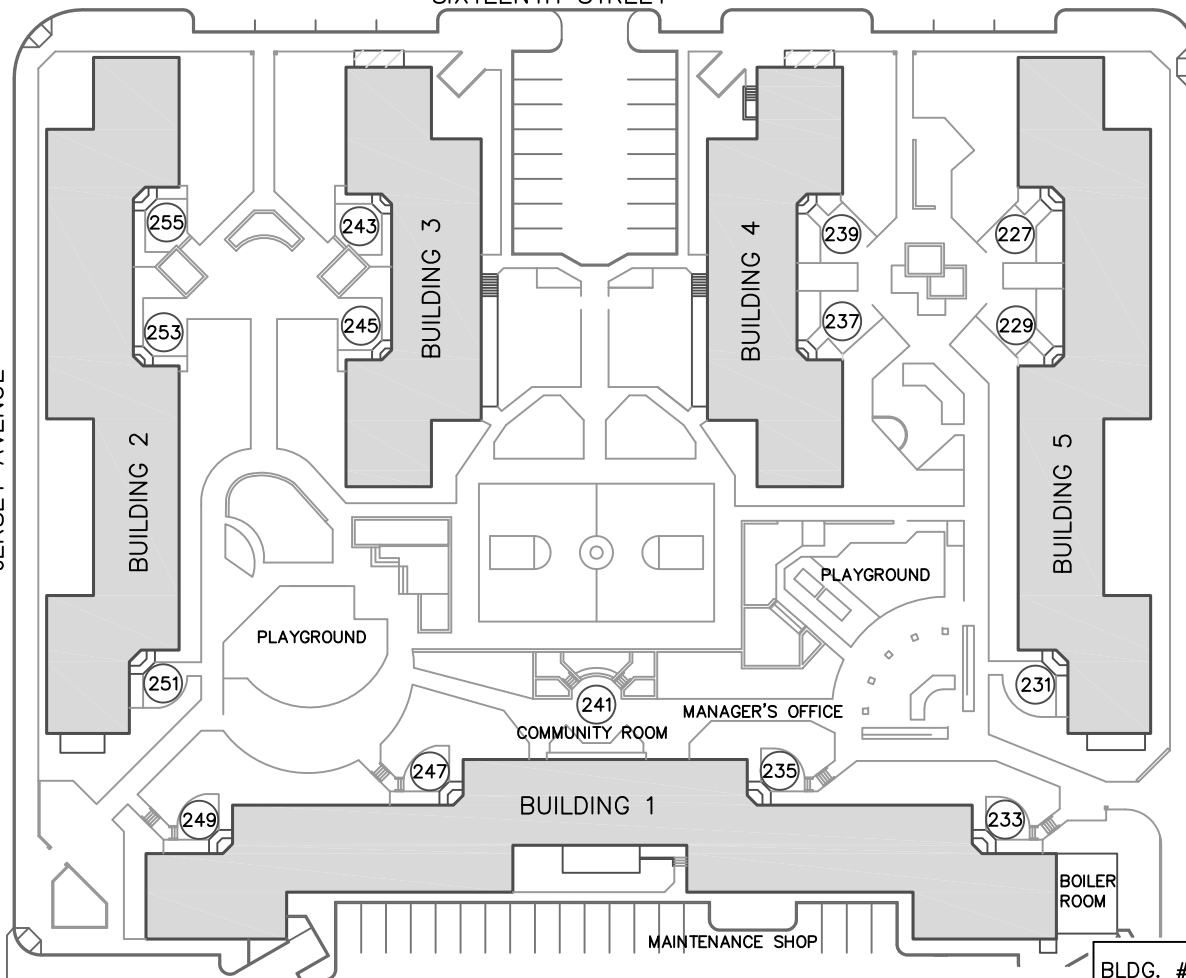

BLDG. #	ADDRESSES	BLDG. AREA*	# OF UNITS
BUILDING 1	233, 235, 241, 247, 249 SIXTEENTH STREET	11,507 SF	56
BUILDING 2	251, 253, 255 SIXTEENTH STREET	8,584 SF	36
BUILDING 3	243, 245 SIXTEENTH STREET	5,354 SF	32
BUILDING 4	237, 239 SIXTEENTH STREET	5,354 SF	32
BUILDING 5	227, 229, 231 SIXTEENTH STREET	8,584 SF	36
TOTALS		39,383 SF	192
TOTAL # OF DWELLING UNITS			189
TOTAL # OF NON-DWELLING UNITS			3

\*GROSS FIRST FLOOR AREA

SITE AREA: 3.31 AC

OLD TAX BLOCK: 290 LOT: 1A



BLDG. #	ADDRESSES	BLDG. AREA*	# OF UNITS
BUILDING 1	561 MONTGOMERY STREET	7,132 SF	76
BUILDING 2	563 MONTGOMERY STREET	7,502 SF	76
BUILDING 3	565 MONTGOMERY STREET	7,132 SF	68
BUILDING 4	567 MONTGOMERY STREET	7,502 SF	75
BUILDING 5	569 MONTGOMERY STREET	7,132 SF	75
BUILDING 6	571 MONTGOMERY STREET	7,502 SF	77
TOTALS		43,902 SF	447
TOTAL # OF DWELLING UNITS			434
TOTAL # OF NON-DWELLING UNITS			13

\*GROSS FIRST FLOOR AREA

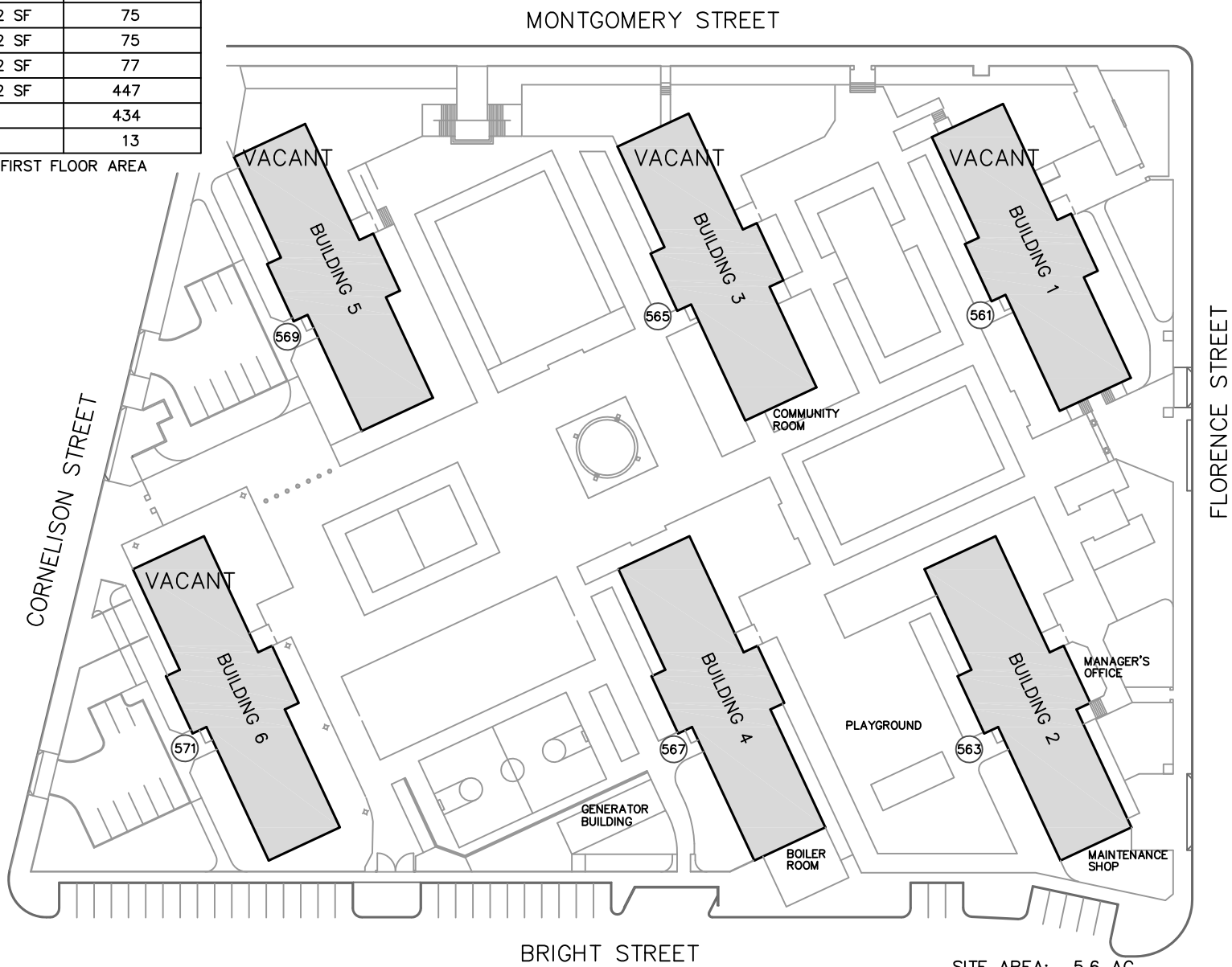

SITE AREA: 5.6 AC  
OLD TAX BLOCK: 2116 LOT: P





PHASE I TOWNHOUSES – 46 UNITS		BLDG. AREA*	PHASE IV TOWNHOUSES – 40 UNITS	BLDG. AREA*
2, 4, 6, 8, 10, 12, 14, 16 HOPE LANE		28,686 SF	40, 42, 44, 46, 48, 50, 52 NEW HECKMAN DRIVE	
24, 26, 27, 28, 29, 30, 31, 32, 33, 34, 35, 37, 39 PEACE DRIVE			54, 56, 58, 60, 62, 64, 66, 68, 70, 72, 74, 76, 78, 80, 82, 84, 86, 88, 90, 92, 94, 96, 98, 100 NEW HECKMAN DRIVE	
32, 34, 36, 38, 40, 42, 44, 46 RUBY BROWN TERRACE			48, 50, 52, 54, 56, 58, 60, 62, 64 RUBY BROWN TERRACE	
13, 15, 17, 19, 21, 23, 25, 27, 29, 31, 33, 35, 37 NEW HECKMAN DRIVE			PHASE V TOWNHOUSES – 80 UNITS	
19, 21, 23, 25 GARDEN TERRACE			126, 128, 130, 132, 134, 136, 138 MERRITT STREET	
PHASE II TOWNHOUSES – 20 UNITS		BLDG. AREA*	10, 12, 14, 16, 18, 20, 22, 24, 26, 28, 30 RUBY BROWN TERRACE	
1, 3, 5, 7 OLD BERGEN ROAD		12,328 SF	6, 7, 8, 9, 10, 11, 12, 13, 14, 15, 16, 17, 18, 19, 20, 21, 22, 23, 25 PEACE DRIVE	
2, 4, 6, 8, 10, 12, 14, 16, 18, 20, 22, 24, 26, 28, 30, 32 NEW HECKMAN DRIVE			4, 5, 6, 7, 8, 9, 10, 11, 12, 13, 14, 15, 16, 17, 18, 20, 22, 24, 26, 28, 30, 32, 34, 36, 38 GARDEN TERRACE	
PHASE III TOWNHOUSES – 18 UNITS		BLDG. AREA*	3, 4, 5, 6, 7, 8, 9, 10, 11, 12, 13, 14, 15, 16, 17, 18, 19, 21 LIGGIONS LANE	
1-1, 1-2, 1A-1, 1A-2 NEW HECKMAN DRIVE		13,524 SF	PHASE I TOWER – 91 UNITS	
112-1, 112-2, 114-1, 114-2, 116-1, 116-2 MERRITT STREET			3 NEW HECKMAN DRIVE	
118-1, 118-2, 120-1, 120-2, 122-1, 122-2, 124-1, 124-2 MERRITT STREET			COMMUNITY REVITALIZATION CENTER	
			65-67 RUBY BROWN TERRACE	
			TOTAL BLDG. AREA*	
			TOTAL # OF DWELLING UNITS	

\*GROSS FIRST FLOOR AREA

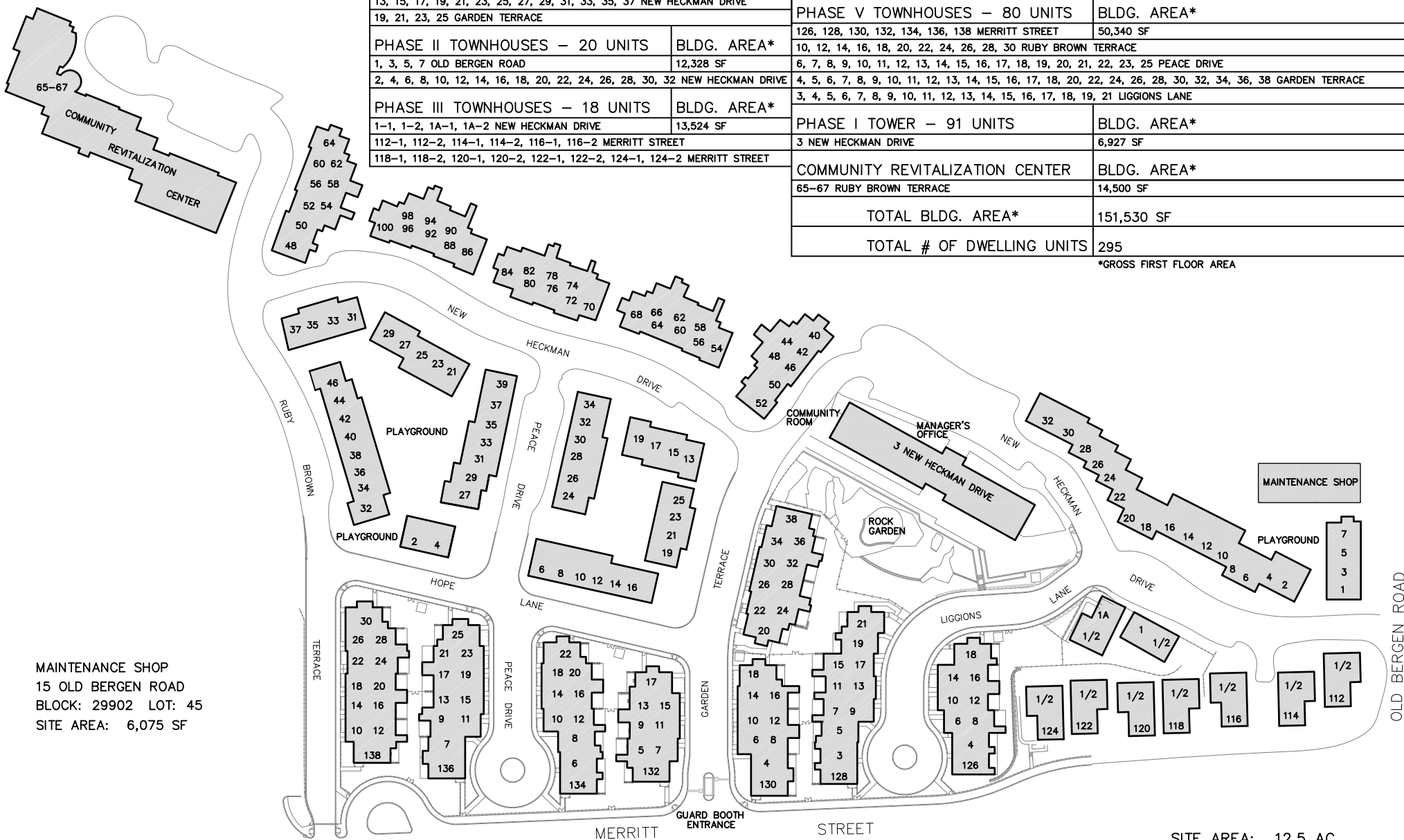

MAINTENANCE SHOP  
15 OLD BERGEN ROAD  
BLOCK: 29902 LOT: 45  
SITE AREA: 6,075 SF

SITE AREA: 12.5 AC  
OLD TAX BLOCK: 1381 LOT: W8



BLDG. #	ADDRESSES	# OF UNITS
BUILDING A	199 OCEAN AVENUE	156
BUILDING B	92 DANFORTH AVENUE	130
BUILDING C	82 DANFORTH AVENUE	40
BUILDING D	72 DANFORTH AVENUE	42
TOTAL # OF UNITS		368
TOTAL # OF DWELLING UNITS		357
TOTAL # OF NON-DWELLING UNITS		11

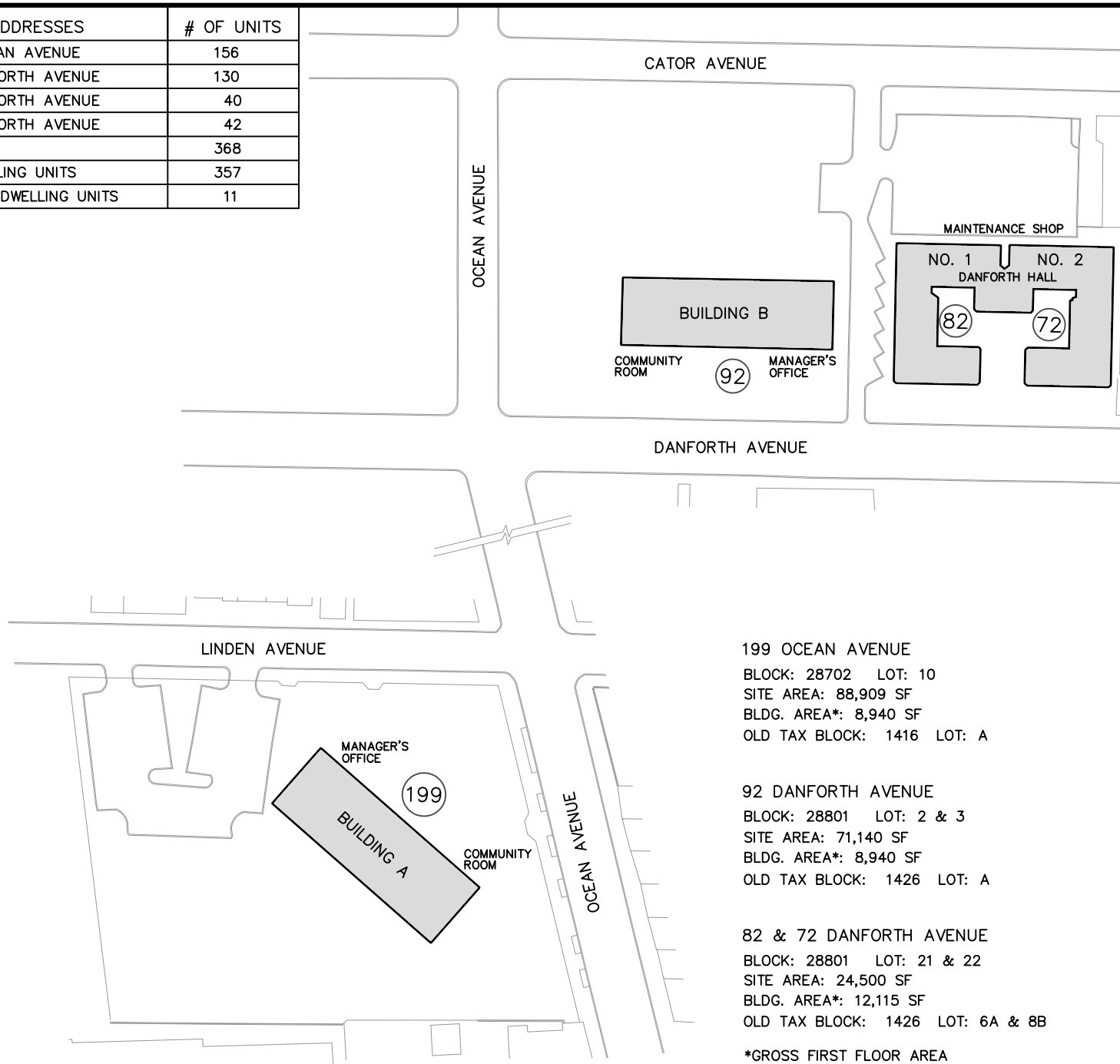

199 OCEAN AVENUE  
 BLOCK: 28702 LOT: 10  
 SITE AREA: 88,909 SF  
 BLDG. AREA\*: 8,940 SF  
 OLD TAX BLOCK: 1416 LOT: A

92 DANFORTH AVENUE  
 BLOCK: 28801 LOT: 2 & 3  
 SITE AREA: 71,140 SF  
 BLDG. AREA\*: 8,940 SF  
 OLD TAX BLOCK: 1426 LOT: A

82 & 72 DANFORTH AVENUE  
 BLOCK: 28801 LOT: 21 & 22  
 SITE AREA: 24,500 SF  
 BLDG. AREA\*: 12,115 SF  
 OLD TAX BLOCK: 1426 LOT: 6A & 8B

\*GROSS FIRST FLOOR AREA



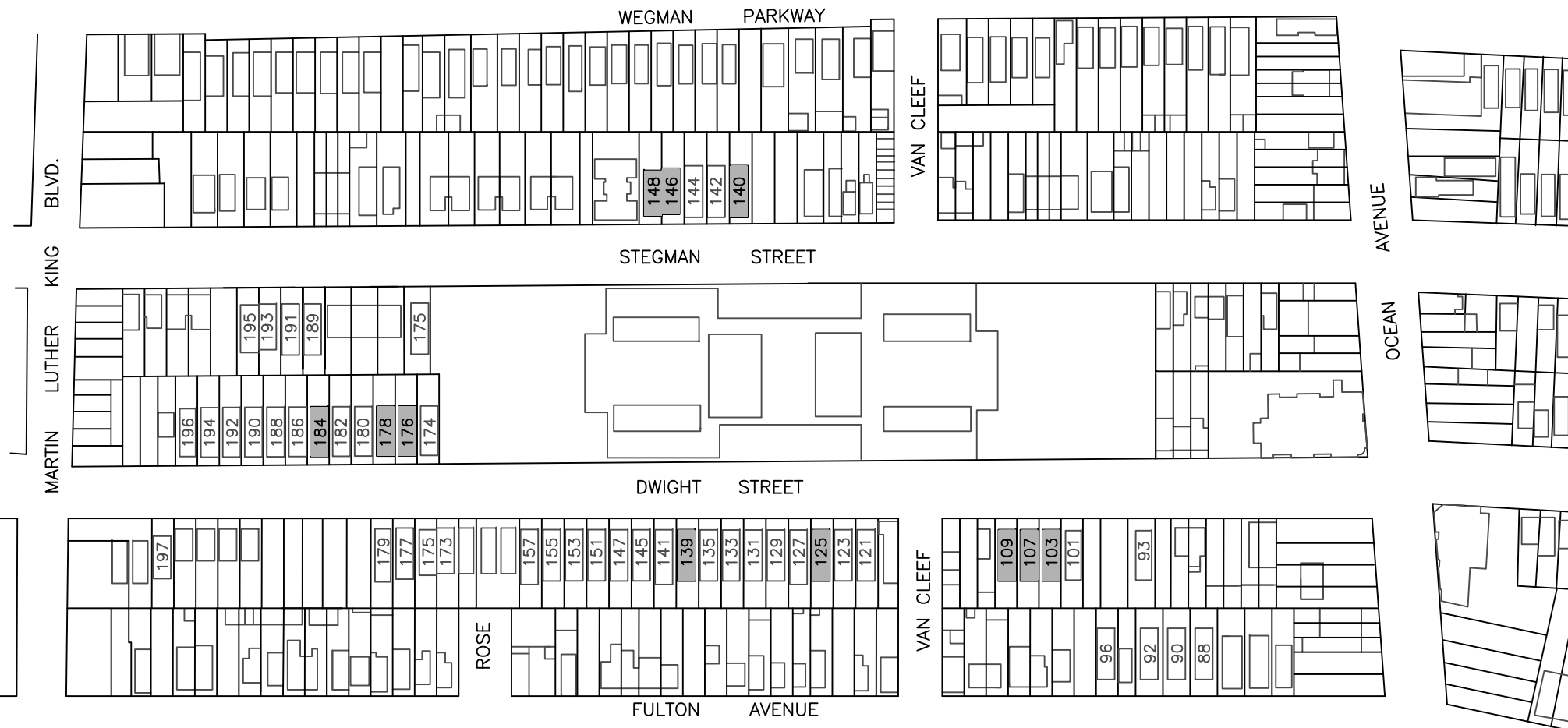

ADDRESSES	OLD BLOCK	OLD LOT	NEW BLOCK	NEW LOT	ADDRESSES	OLD BLOCK	OLD LOT	NEW BLOCK	NEW LOT	ADDRESSES	OLD BLOCK	OLD LOT	NEW BLOCK	NEW LOT
103A & 103B DWIGHT STREET	1331	15	25804	7	139A & 139B DWIGHT STREET	1330	55	25704	11	140A & 140B STEGMAN STREET	1318	200	25001	42
107A & 107B DWIGHT STREET	1331	14	25804	6	176A & 176B DWIGHT STREET	1326	100	25101	38	146 STEGMAN STREET	1318	197	25001	45
109A & 109B DWIGHT STREET	1331	13	25804	5	178A & 178B DWIGHT STREET	1326	101	25101	39	148 STEGMAN STREET	1318	190	25101	46
125A & 125B DWIGHT STREET	1330	61	25704	17	184A & 184B DWIGHT STREET	1326	104	25101	42					

BLDG. #	NEW BLOCK #	NEW LOT #	OLD BLOCK #	OLD LOT #	SITE AREA	BLDG. AREA*	# OF UNITS
BUILDINGS 1 - 12	15502	1	2086	39	2.09 AC	25,316 SF	44
BUILDING 34	"	"	"	"	"	2,935 SF	0
BUILDINGS 13 - 21	15503	1	2087.1	2	1.74 AC	25,501 SF	47
BUILDINGS 22 - 33	15502	2	2087.1	1	1.96 AC	18,491 SF	33
TOTAL					5.79 AC	72,243 SF	124
						TOTAL # OF ACC UNITS	77

\*GROSS FIRST FLOOR AREA

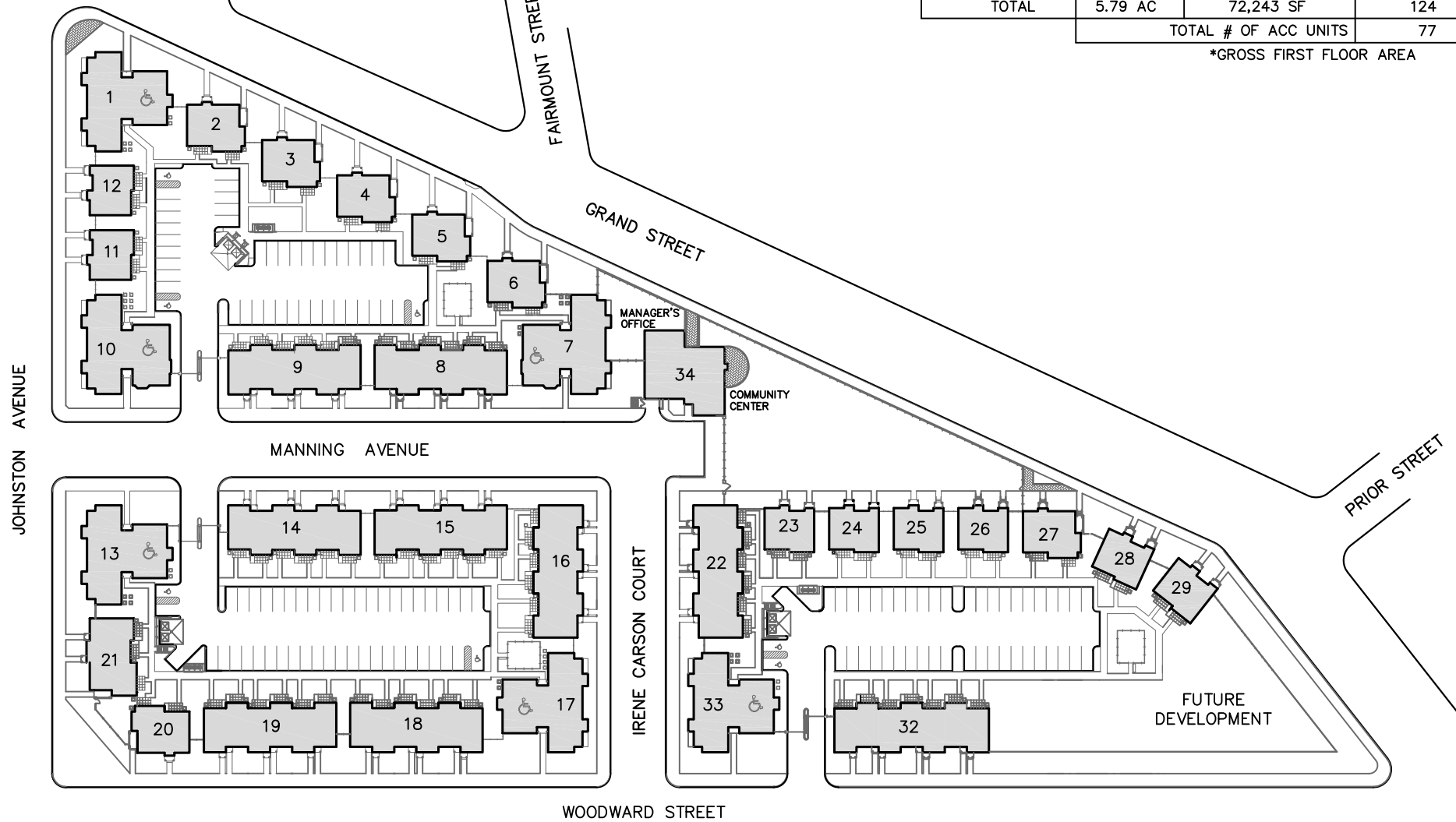

BLDG. #	ADDRESSES	BLDG. AREA*	# OF UNITS
BUILDING 1	601, 603, 605, 607, 609, 611 GRAND STREET	3,128 SF	6
BUILDING 2	597, 599 GRAND STREET	1,346 SF	2
BUILDING 3	593, 595 GRAND STREET	1,346 SF	2
BUILDING 4	589, 591 GRAND STREET	1,346 SF	2
BUILDING 5	585, 587 GRAND STREET	1,346 SF	2
BUILDING 6	581, 583 GRAND STREET	1,346 SF	2
BUILDING 7	135, 137, 139, 141, 143, 145 MANNING AVENUE	3,342 SF	6
BUILDING 8	123, 125, 127, 129, 131, 133 MANNING AVENUE	3,214 SF	6
BUILDING 9	111, 113, 115, 117, 119, 121 MANNING AVENUE	3,214 SF	6
BUILDING 10	93, 95, 97, 99, 101, 103 MANNING AVENUE	3,342 SF	6
BUILDING 11	434, 436 JOHNSTON AVENUE	1,173 SF	2
BUILDING 12	438, 440 JOHNSTON AVENUE	1,173 SF	2
BUILDING 34	579 GRAND STREET (MANAGEMENT BLDG.)	2,935 SF	0
TOTALS (THIS BLOCK)		25,316 SF	44

\*GROSS FIRST FLOOR AREA

JOHNSTON AVENUE

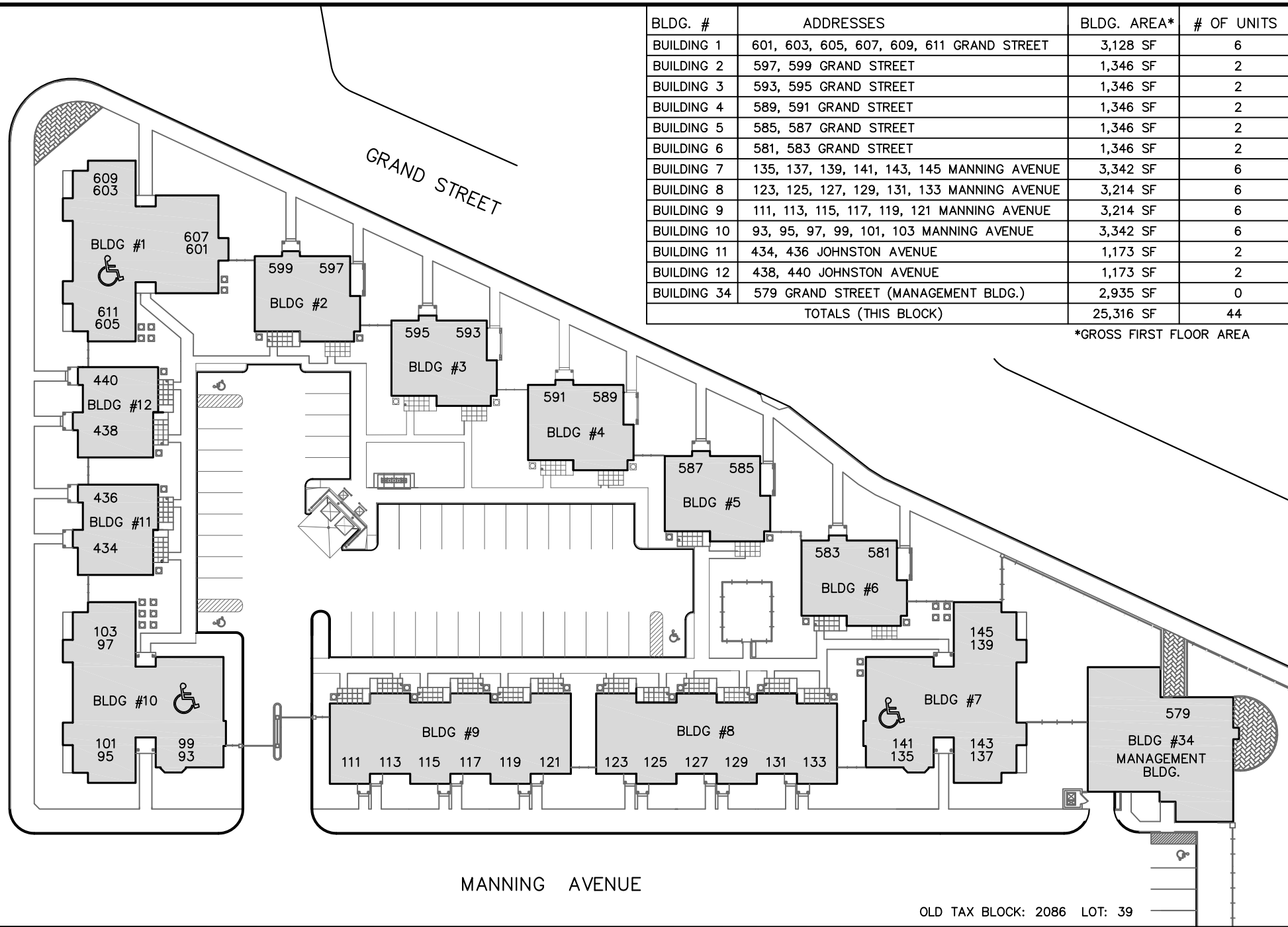

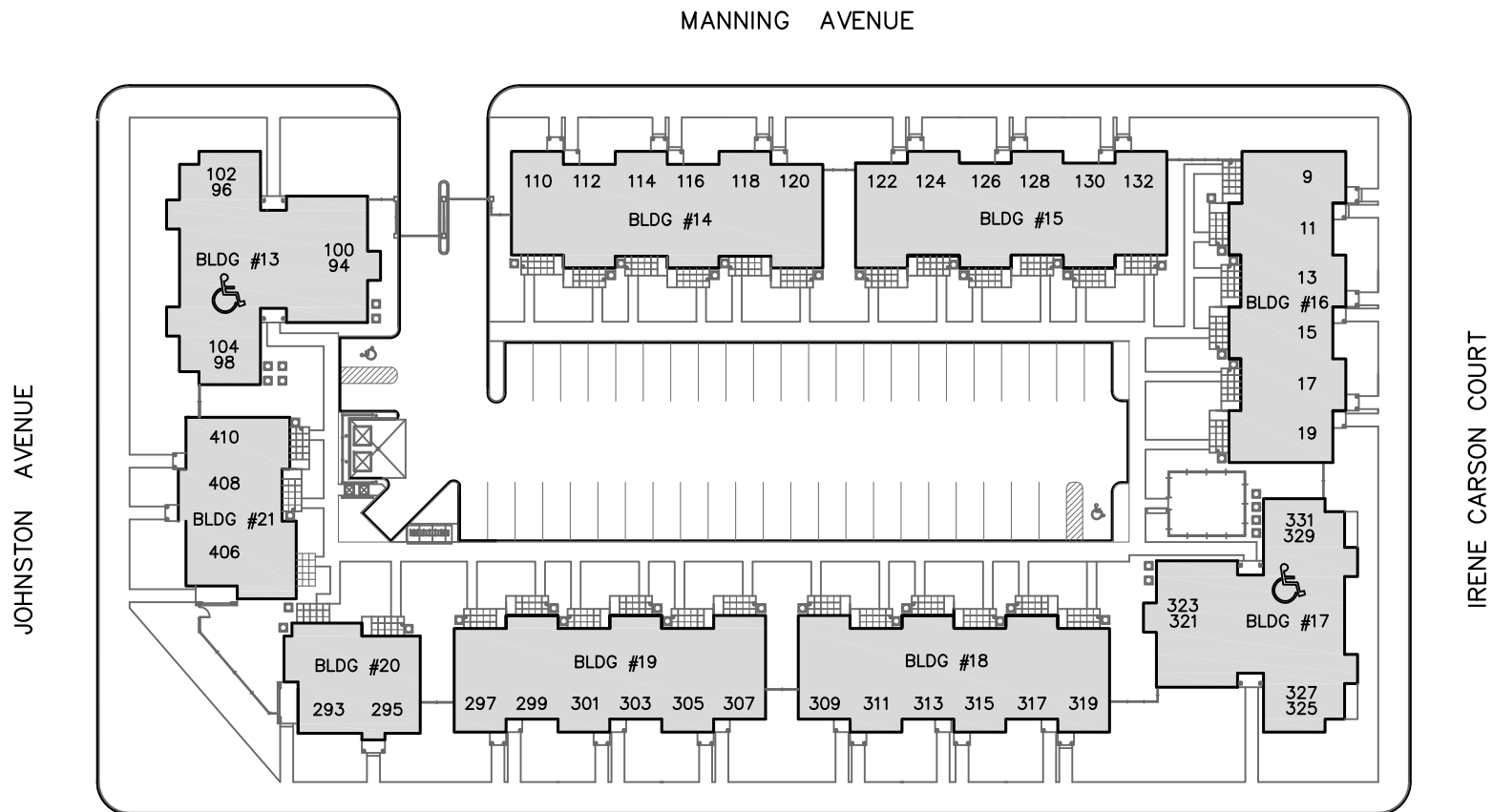

BLDG. #	ADDRESSES	BLDG. AREA*	# OF UNITS
BUILDING 13	94, 96, 98, 100, 102, 104 MANNING AVENUE	3,128 SF	6
BUILDING 14	110, 112, 114, 116, 118, 120 MANNING AVENUE	3,214 SF	6
BUILDING 15	122, 124, 126, 128, 130, 132 MANNING AVENUE	3,214 SF	6
BUILDING 16	9, 11, 13, 15, 17, 19 IRENE CARSON COURT	3,214 SF	6
BUILDING 17	321, 323, 325, 327, 329, 331 WOODWARD STREET	3,128 SF	6
BUILDING 18	309, 311, 313, 315, 317, 319 WOODWARD STREET	3,214 SF	6
BUILDING 19	297, 299, 301, 303, 305, 307 WOODWARD STREET	3,214 SF	6
BUILDING 20	293, 295 WOODWARD STREET	1,346 SF	2
BUILDING 21	406, 408, 410 JOHNSTON AVENUE	1,829 SF	3
TOTALS (THIS BLOCK)		25,501 SF	47

\*GROSS FIRST FLOOR AREA

OLD TAX BLOCK: 2087.1 LOT: 2



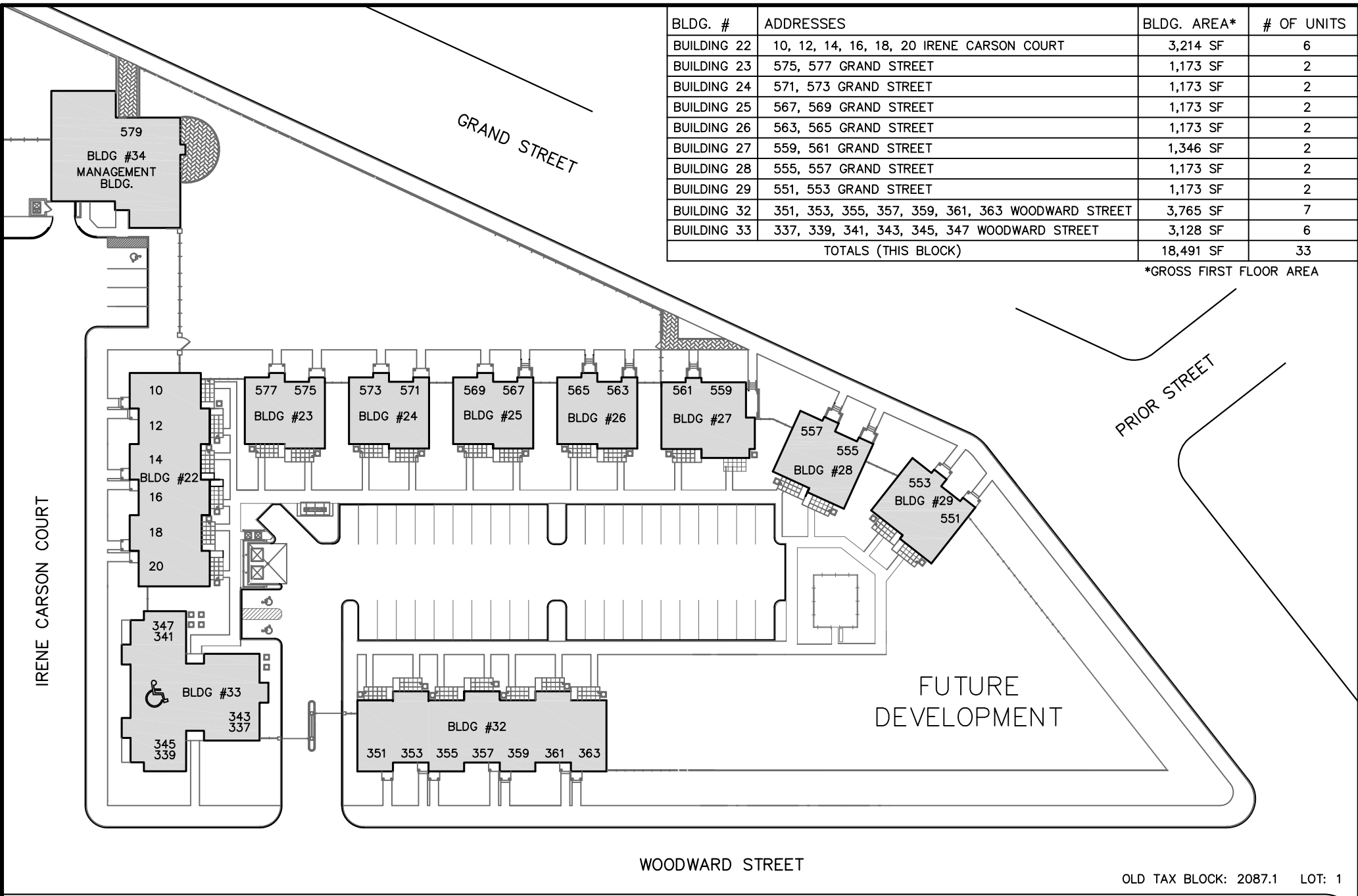

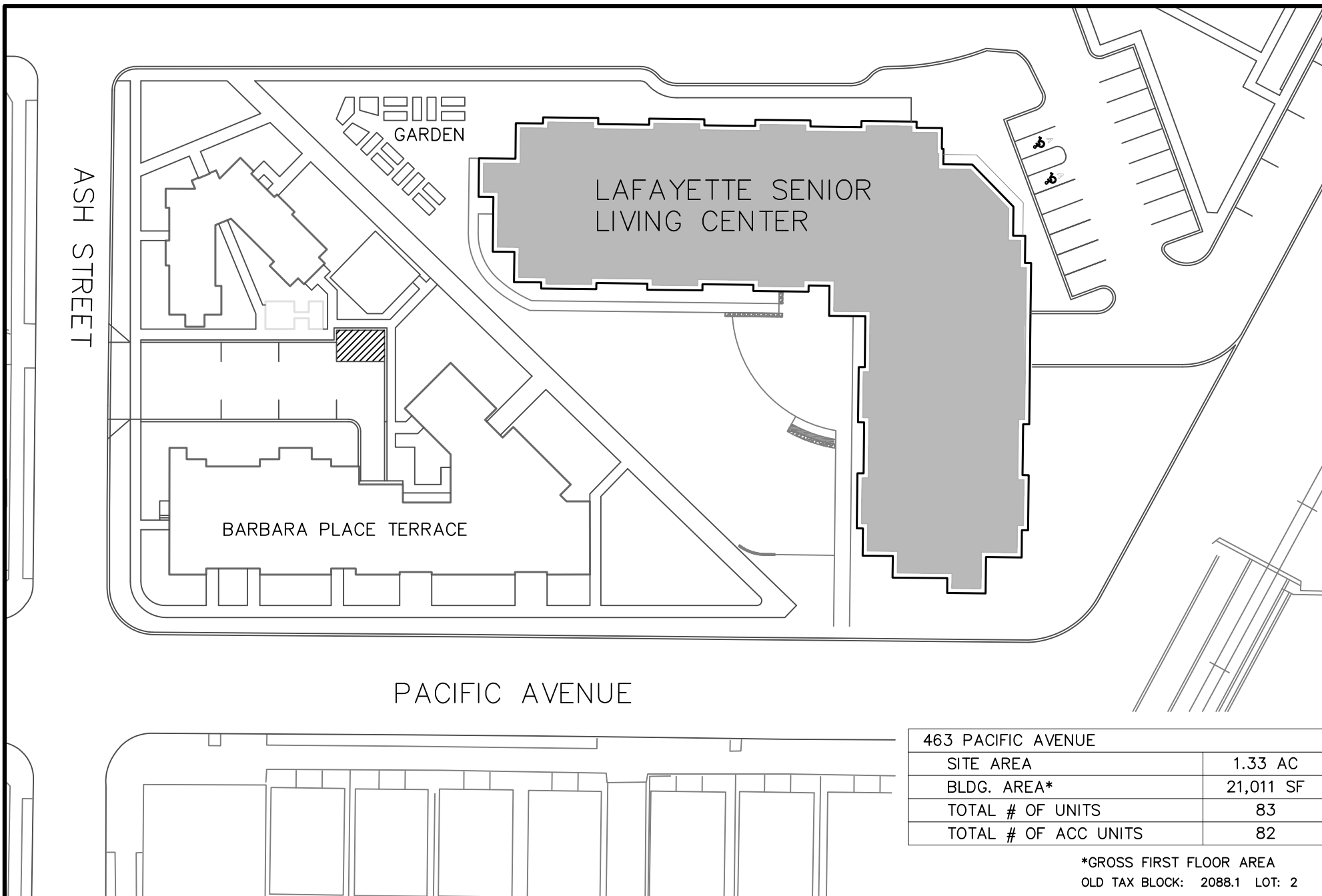

463 PACIFIC AVENUE	
SITE AREA	1.33 AC
BLDG. AREA*	21,011 SF
TOTAL # OF UNITS	83
TOTAL # OF ACC UNITS	82

\*GROSS FIRST FLOOR AREA  
OLD TAX BLOCK: 2088.1 LOT: 2







# L A F A Y E T T E V I L L A G E

## WOODWARD STREET

JAMES "POP" CURRY DRIVE

WALTER MAYS DRIVE

## VAN HORNE STREET

CARBON

<b>BUILDING 1</b>	302-1 WOODWARD STREET 16-2, 14-2, 14-1, 12-2, 12-1, 10-2, 10-1, 8-2, 8-1, 6-2, 6-1, 4-2 JAMES "POP" CURRY DRIVE 345-1 VAN HORNE STREET	<b>BUILDING 2</b>	312-1, 312-2, 312-3, 314-2, 314-1, 316-2, 316-1, 318-2, 318-1, 320-2, 320-1, 322-2, 322-1, 324 WOODWARD STREET	<b>BUILDING 3</b>	351, 353-2, 353-1, 355-2, 355-1, 357-2, 357-1, 359-2, 359-1, 361-2, 361-1, 363-3, 363-2, 363-1 VAN HORNE STREET
14 UNITS		14 UNITS		14 UNITS	
7,669 SF*		7,579 SF*		7,579 SF*	
<b>BUILDING 4</b>	322-1 WOODWARD STREET 15-2, 13-2, 13-1, 11-2, 11-1, 9-2, 9-1, 7-2, 7-1, 5-2, 5-1, 3-2 WALTER MAYS DRIVE 377-1 VAN HORNE STREET	<b>BUILDING 5</b>	334-1 WOODWARD STREET 16-2, 14-2, 14-1, 12-2, 12-1, 10-2, 10-1, 8-2, 8-1, 6-2, 6-1, 4-2 WALTER MAYS DRIVE 379-1 VAN HORNE STREET	<b>SITE AREA:</b> 2.31 AC <b>TOTAL BLDG. AREA*:</b> 38,165 SF <b>TOTAL # OF UNITS:</b> 70 <b>TOTAL # OF ACC UNITS:</b> 45	
14 UNITS		14 UNITS			
7,669 SF*		7,669 SF*			

\*GROSS FIRST FLOOR AREA  
OLD TAX BLOCK: 2088 LOT: 1.2



ERIE ST

FIFTH ST

COMMUNITY  
ROOM

MANAGER'S  
OFFICE

PARKING

PARKING

88-92 ERIE STREET

SITE AREA	0.23 AC
BLDG. AREA*	6,835 SF
TOTAL # OF DWELLING UNITS	48
TOTAL # OF NON-DWELLING UNITS	0

\*GROSS FIRST FLOOR AREA

OLD TAX BLOCK: 247 LOT: T,R,V2



BLDG.#	ADDRESSES	# OF UNITS
PHASE I, N.J. 9-17		
BUILDING A		24
11,612 SF*	39, 41, 43, 45, 47, 49, 51, 53, 55, 57, 59, 61, 63, 65, 67, 69 71, 73, 75, 77, 79, 81, 83, 85 HARVEY AVENUE 87 HARVEY AVENUE (METER ROOM)	
BUILDING B		42
16,612 SF*	8, 10, 12, 16, 20, 22, 26, 28, 30 HARVEY AVE. 7, 11, 13, 15, 19, 21, 23, 27, 29, 31 MARCY PLACE 18 HARVEY AVENUE (METER ROOM) 25 MARCY PLACE (METER ROOM)	
PHASE II, N.J. 9-19		
BUILDING C		18
6,487 SF*	4 HARVEY AVENUE 5 MARCY PLACE 354, 358 DUNCAN AVENUE 352, 360 DUNCAN AVE. (METER ROOM)	
BUILDING D		24
8,148 SF*	340, 344, 348 DUNCAN AVENUE 6 MARCY PLACE (METER ROOM)	
BUILDING E		36
14,057 SF*	10, 12, 14, 18, 20, 24, 28, 30, 32 MARCY PLACE 11, 13, 15, 19, 23, 25, 29, 31, 33 GLORIA ROBINSON COURT 22 MARCY PLACE (METER ROOM) 21 GLORIA ROB. CT. (METER ROOM)	
SITE AREA: 4.19 AC		
TOTAL BLDG. AREA*: 56,916 SF		
TOTAL UNITS:		144
PHASE I TOTAL ACC UNITS:		58
PHASE II TOTAL ACC UNITS:		71

\*GROSS FIRST FLOOR AREA

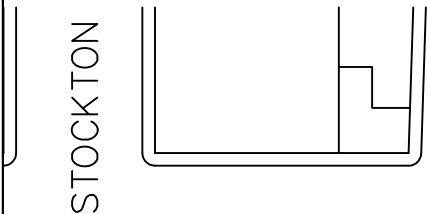

STATE HIGHWAY NO. 1

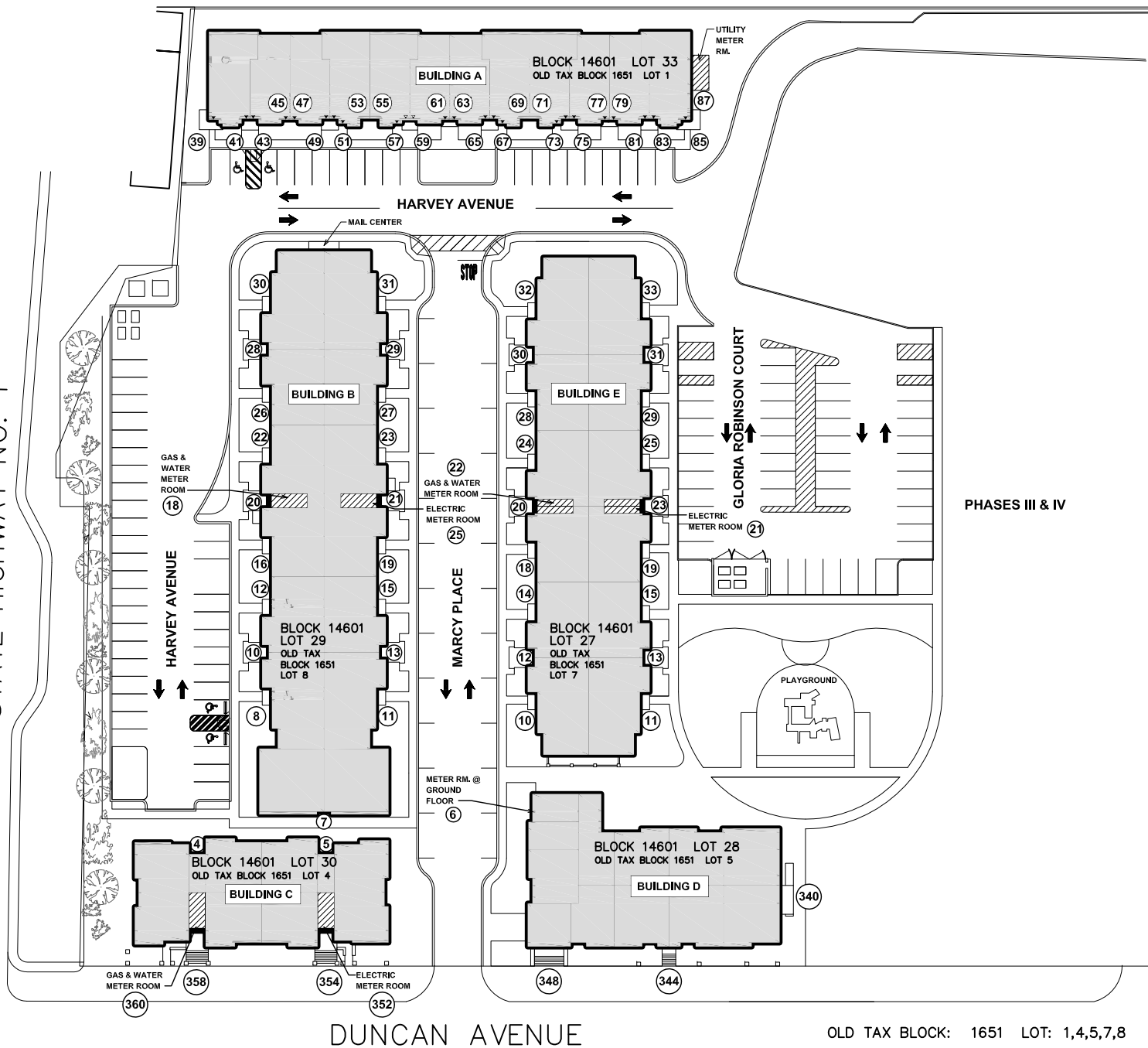

OLD TAX BLOCK: 1651 LOT: 1,4,5,7,8



PROJECT N.J. 9-17, 9-19  
GLORIA ROBINSON COURT HOMES  
PHASE I & II  
JERSEY CITY, NJ 07306

SITE PLAN  
BLOCK: 14601 LOT: 27-30, 33  
REVISED: 01/2014

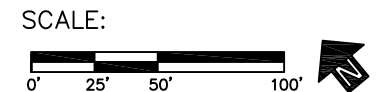

X:\JCHA Site Maps\Updated 2014 with New Tax Block-Lot #'s\NJ9-17, 9-19 Gloria Robinson Court Homes Phase I & Phase II.dwg\asg

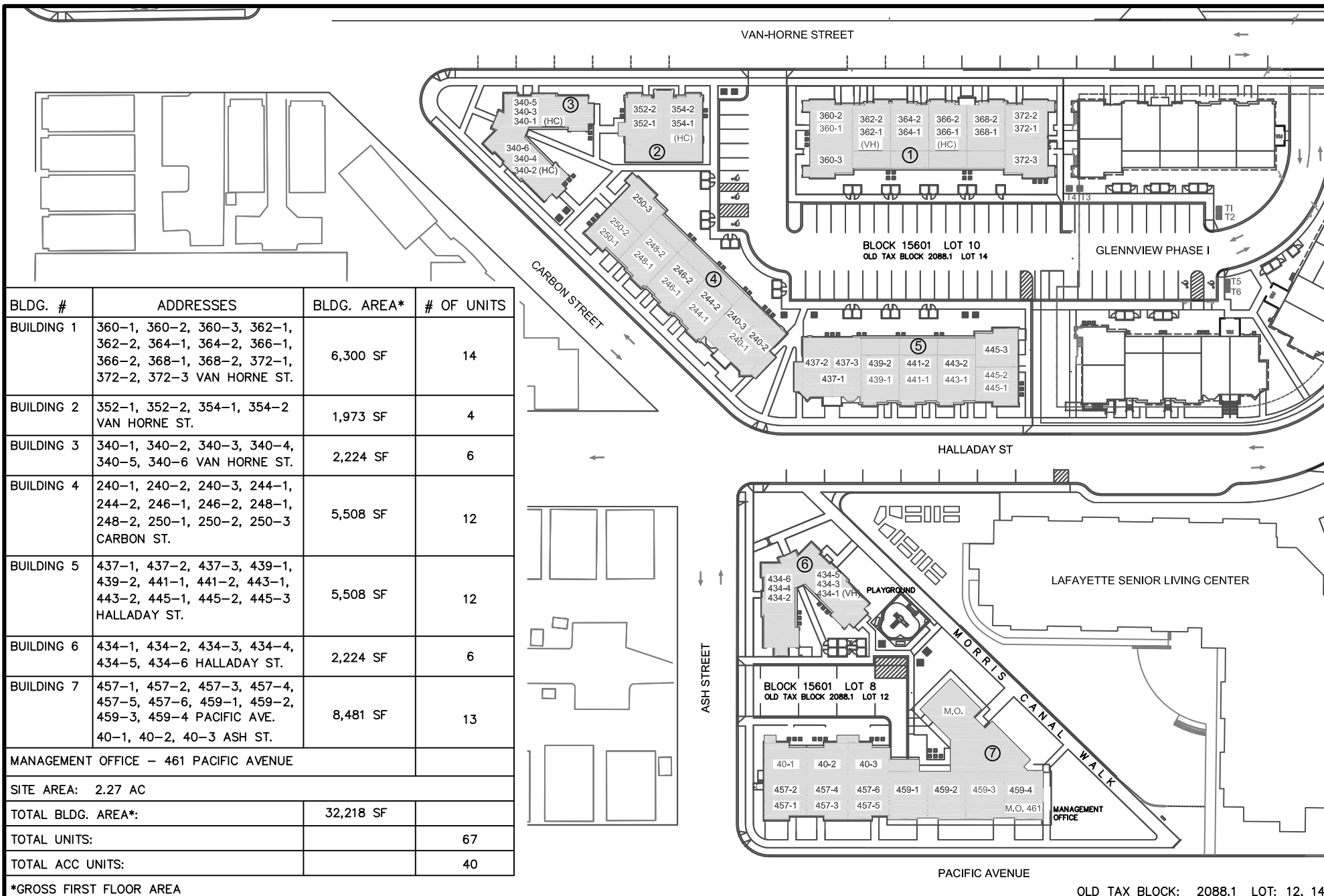



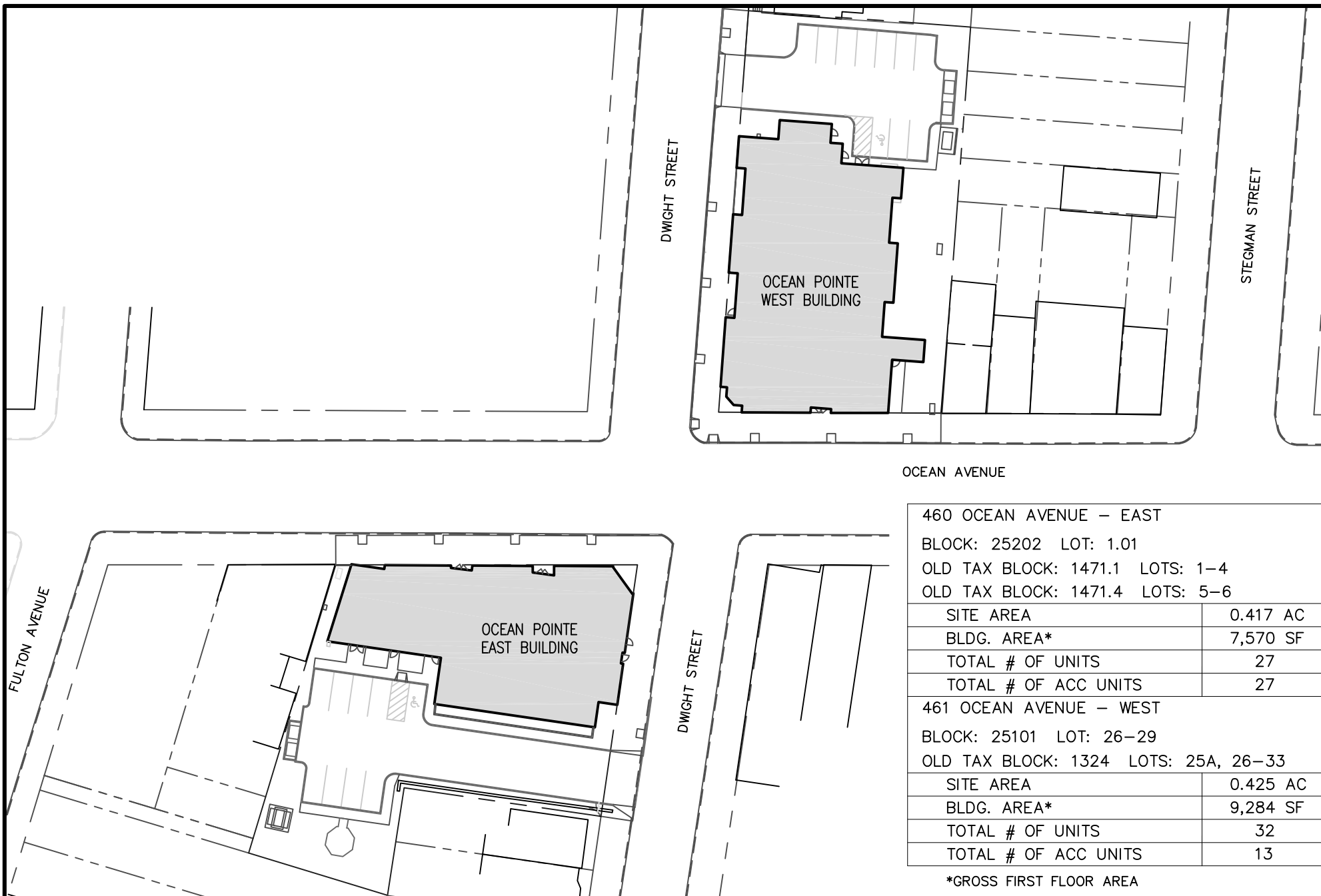



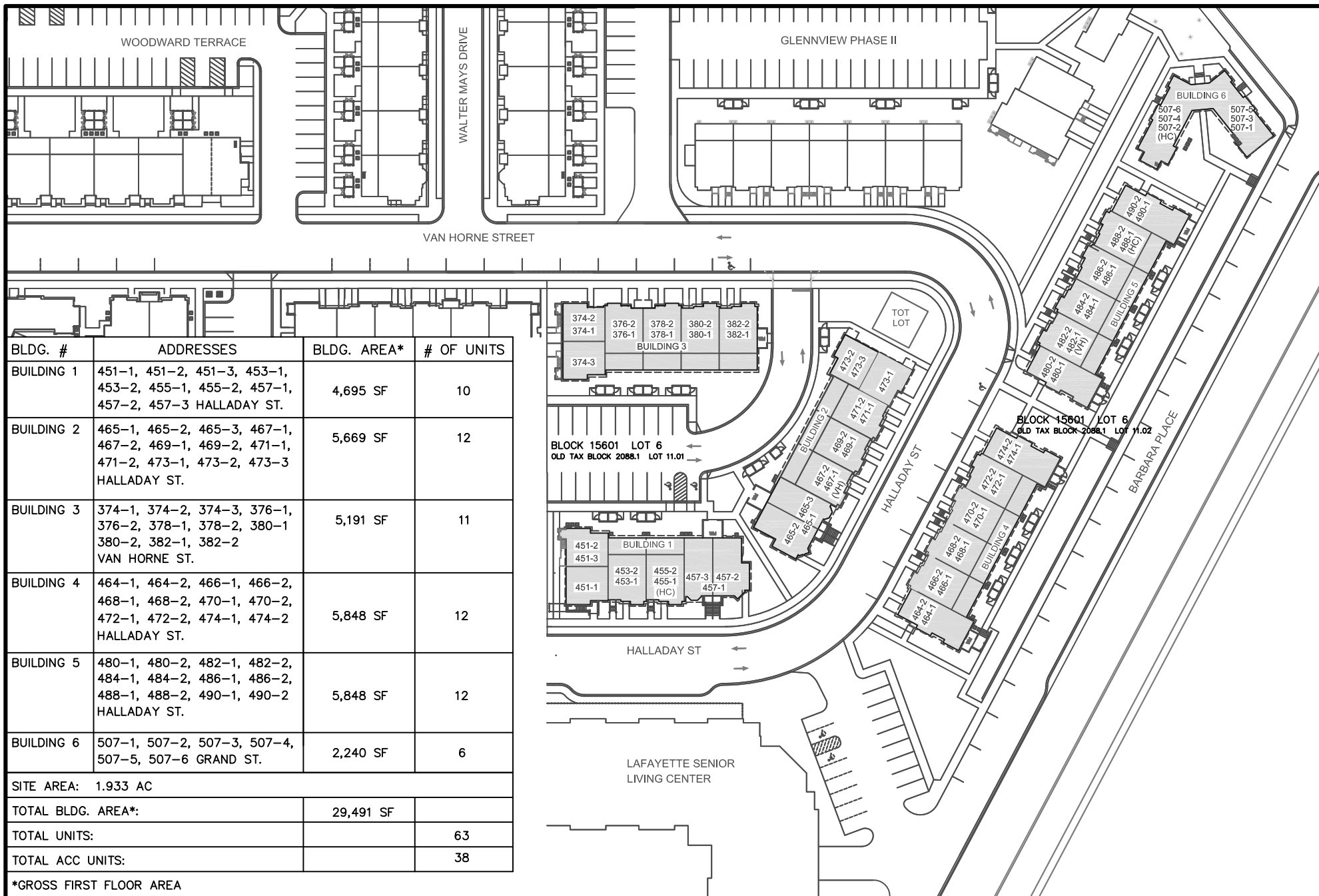

BLDG.#	ADDRESSES	# OF UNITS
PHASE III, N.J. 9-22		
BUILDING F		24
11,612 SF	99, 101, 103, 105, 107, 109, 111, 113, 115, 117, 119, 121, 123, 125, 127, 129, 131, 133, 135, 137, 139, 141, 143, 145 HARVEY AVENUE METER ROOM: 97 HARVEY AVENUE	
BUILDING G		36
14,057 SF	10, 12, 14, 18, 20, 24, 28, 30, 32 GLORIA ROBINSON COURT 11, 13, 15, 19, 23, 25, 29, 31, 33 WILMOT AVENUE METER ROOMS: 22 GLORIA ROBINSON COURT 21 WILMOT AVENUE	
SITE AREA: 1.92 AC		
TOTAL BLDG. AREA*: 25,669 SF		
TOTAL UNITS:		60
PHASE III TOTAL ACC UNITS:		24
*GROSS FIRST FLOOR AREA		

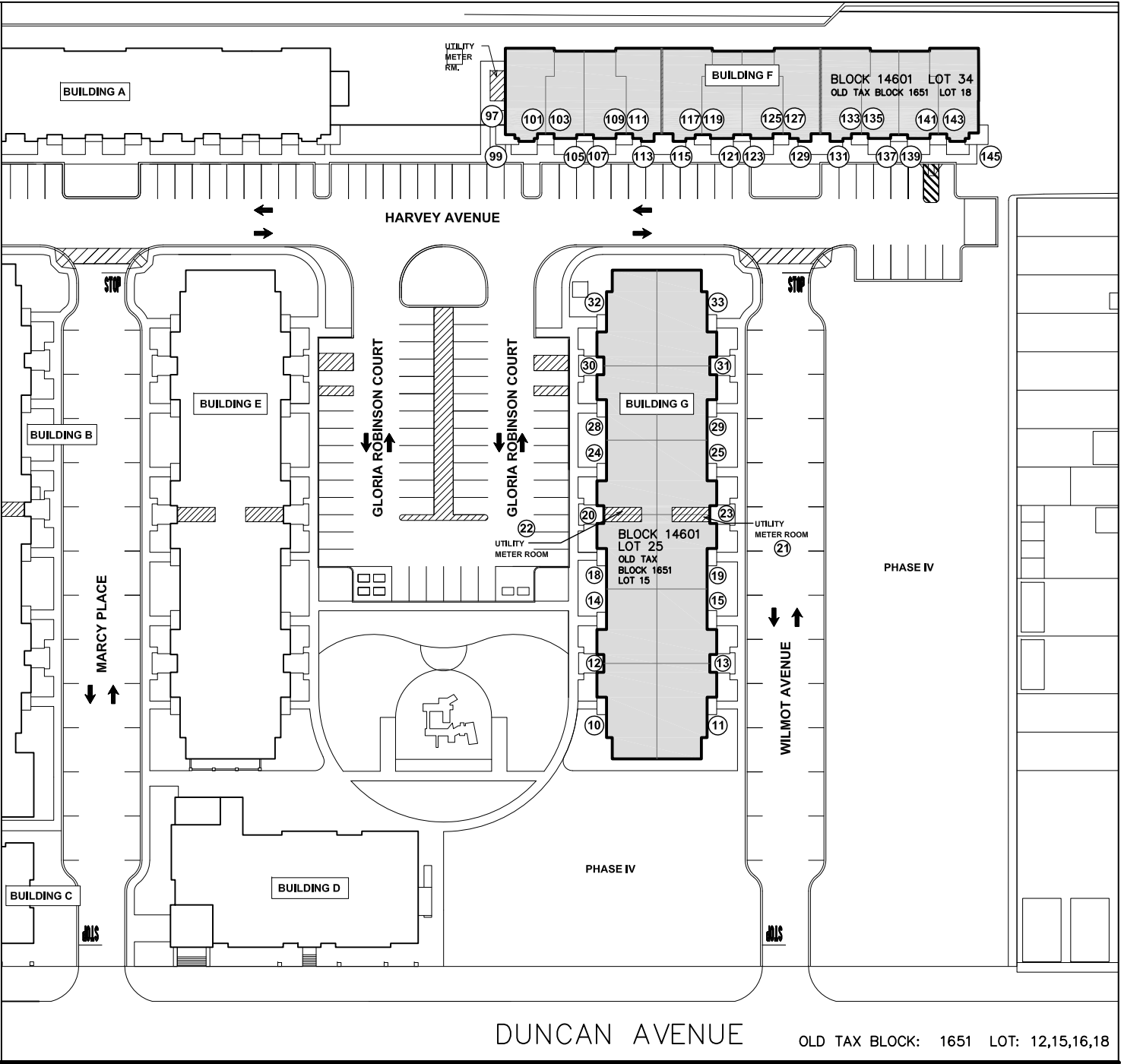

BERGEN AVENUE

GRANT STREET

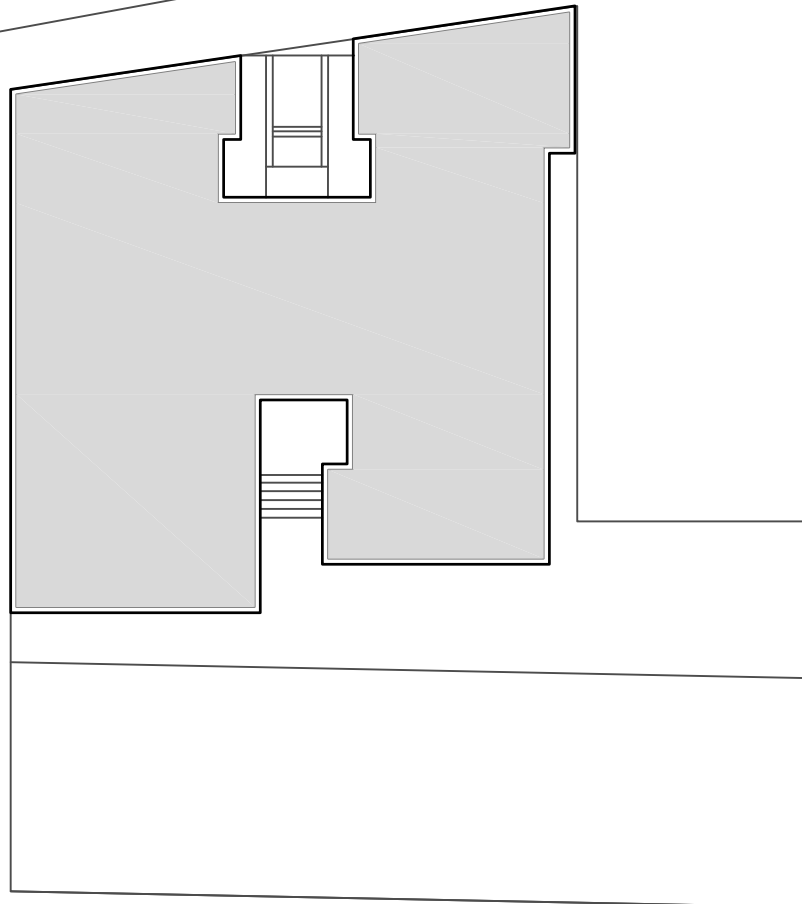

254 BERGEN AVENUE	
SITE AREA	0.27 AC
BLDG. AREA*	8,000 SF
TOTAL # OF DWELLING UNITS	36
TOTAL # OF NON-DWELLING UNITS	0

\*GROSS FIRST FLOOR AREA

OLD TAX BLOCK: 1985 LOT: L16



BLDG. #	ADDRESSES	BLDG. AREA*	# OF UNITS
BUILDING 1	301, 311 RANDOLPH AVENUE	5,314 SF	18
BUILDING 2	305, 309 RANDOLPH AVENUE	5,314 SF	18
BUILDING 3	380, 382 ARLINGTON AVENUE	5,314 SF	18
BUILDING 4	388, 390 ARLINGTON AVENUE	5,314 SF	18
BUILDING 5	315, 325 RANDOLPH AVENUE	5,314 SF	18
TOTALS		26,570 SF	90
TOTAL # OF DWELLING UNITS			90
TOTAL # OF NON-DWELLING UNITS			0

\*GROSS FIRST FLOOR AREA

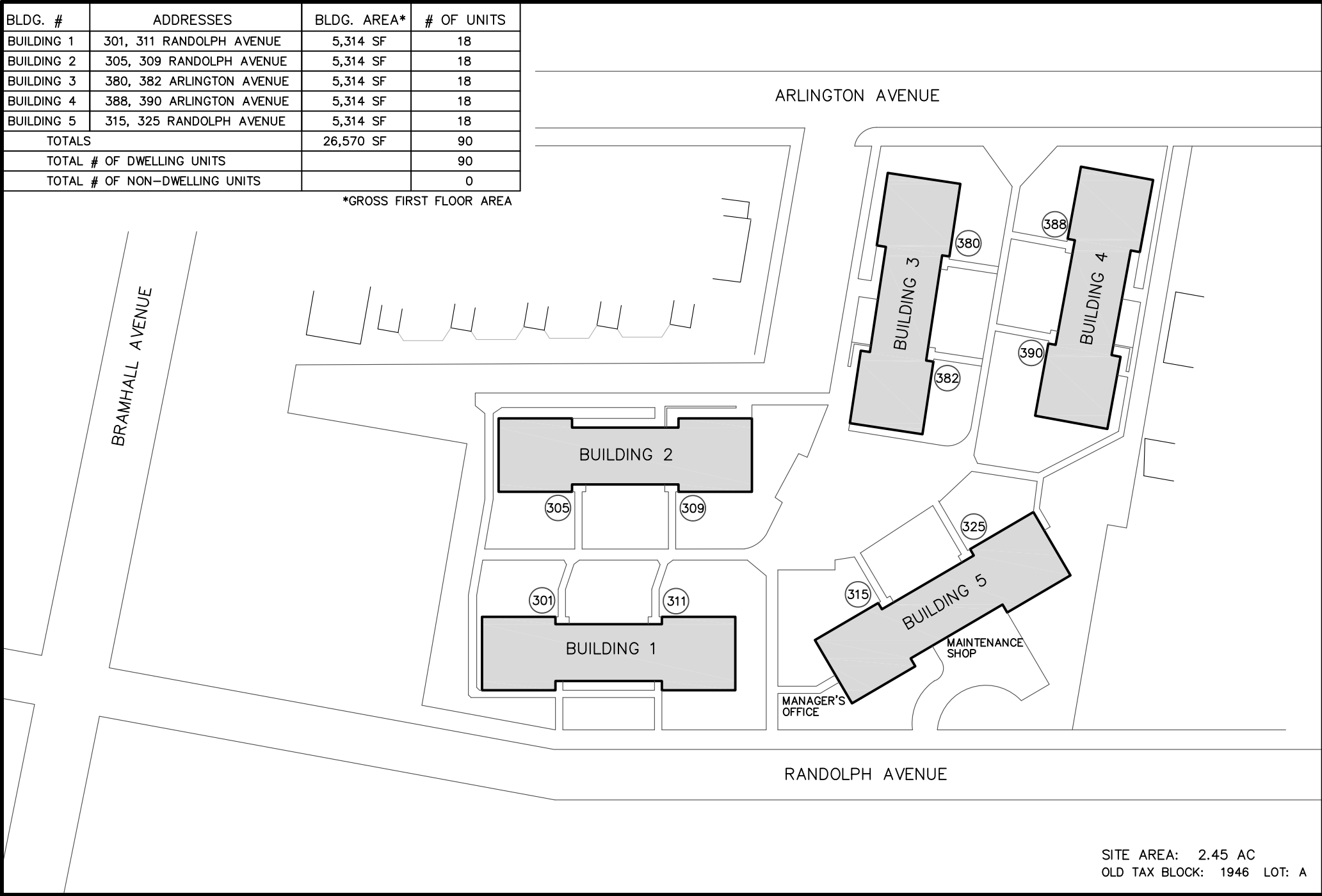

SITE AREA: 2.45 AC  
OLD TAX BLOCK: 1946 LOT: A